



Cablemaster — Coil Spring Guide Kit #KSIL45C

To correct the installation of the coil spring guide assembly on a Silverton 45C, follow the instructions below:

STEP 1: DISCONNECT COIL SPRING BRACKET FROM POWER UNIT

Locate and disconnect the coil spring bracket (PN 50462) from the Cablemaster power unit by removing the 3/8" - 16 bolt.



STEP 2: DISCONNECT COIL SPRING BRACKET FROM COIL SPRING

Disconnect the coil spring bracket (PN 50462) from the Coil Spring (PN 60142-66) by removing the (2) 1/4" - 20 U-bolts.

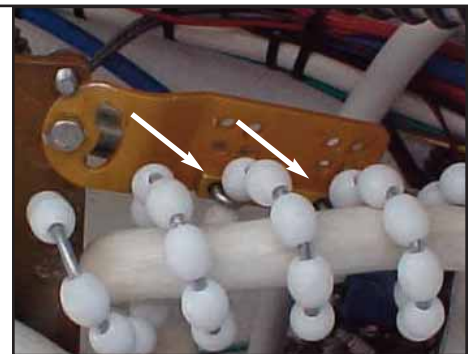

STEP 3: REATTACH COIL SPRING BRACKET ...

Reattach the coil spring bracket to the coil spring using the center set of holes on the coil spring bracket. Make sure that the (2) 1/4" - 20 U-bolts are attached beginning with the 4th turn of the coil spring and that the black plastic push cap (PN 85455) is at the top of the coil where attached to the power unit.

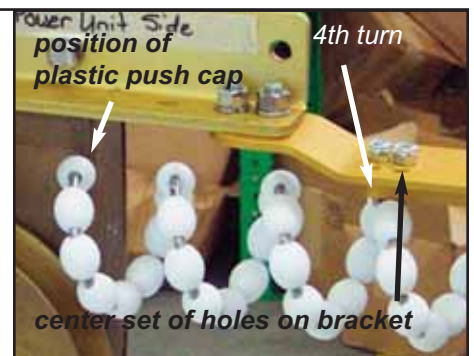

STEP 4: ATTACH CONNECTOR LINK TO POWER UNIT

Attach the connector link (PN 50005) to the Cablemaster power unit as shown using the (2) 3/8" bolts provided.

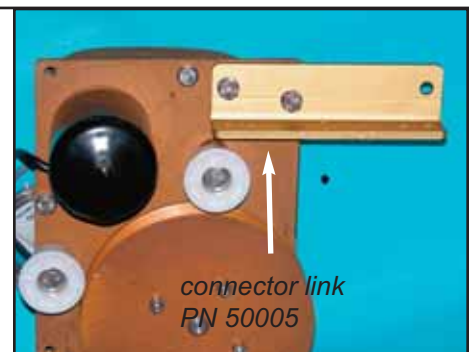

STEP 5: ATTACH COIL SPRING ASSEMBLY TO CONNECTOR LINK

Attach the coil spring bracket (PN 50462) and the coil spring assembly to the connector link with the (2) 3/8" bolts provided.



STEP 6: VERIFY CORRECT INSTALLATION AT HAWSE PIPE

At the hawse pipe, verify that the connector link and coil spring bracket are connected to the hawse pipe (see photo). It is **IMPORTANT** to note that the coil spring should be connected to the coil spring bracket at the 3rd turn of the coil spring. **NOTE:** the coil spring bracket should **NOT** be bent in any manner other than already done or approved by Glendinning Marine Products, Inc. Any unauthorized bending of the bracket will result in improper operation of the Cablemaster.

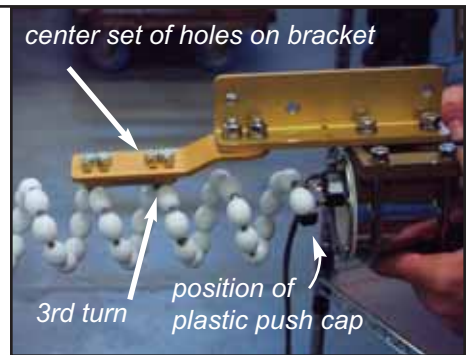

CORRECT INSTALLATION of KIT #KSIL45C

TOOLS NEEDED:
 — 7/16" wrench
 — 9/16" wrench

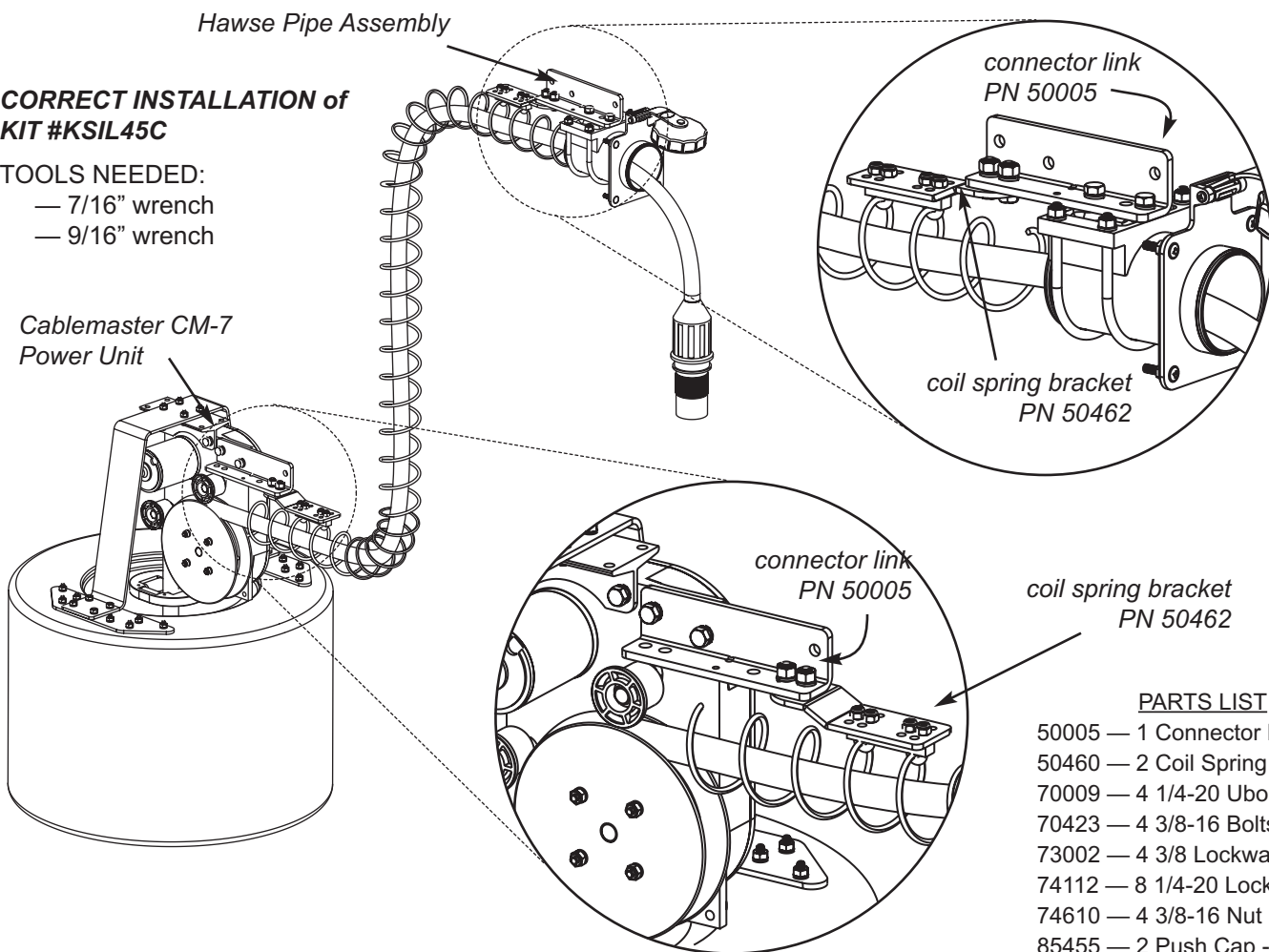

- PARTS LIST**
- 50005 — 1 Connector Link
 - 50460 — 2 Coil Spring Spacers
 - 70009 — 4 1/4-20 Ubolts
 - 70423 — 4 3/8-16 Bolts
 - 73002 — 4 3/8 Lockwashers
 - 74112 — 8 1/4-20 Locknut nylon
 - 74610 — 4 3/8-16 Nut
 - 85455 — 2 Push Cap - Plastic



740 Century Circle
 Conway, SC 29526

(843) 399-6146
 (843) 399-5005

www.glendinningprods.com
 TB_KSIL45C_v1.0